

# High Pressure Blower

for Pneumatic Conveying

IPMA INDUSTRY SDN. BHD.

益马工业有限公司

198501004398 (136837-P)



Model : HPB-55 / HPB-150 / HPB-200



Model	Power Requirement	Max. air flow rate m <sup>3</sup> /h	Max. Pressure (mm WG)	Weight	Dimension(MM) (L x W x H)
<b>Direct drive blowers</b>					
HPB-55	5.5 HP x 2P	1800 m <sup>3</sup> /h	650 mm WG		464 x 938 x 825
HPB-200	20 HP x 2P	1800 m <sup>3</sup> /h	1700 mm WG		441 x 679 x 627
<b>V-belt drive blowers</b>					
HPB-150	15 HP x 2P	1800 m <sup>3</sup> /h	1300 mm WG	208 KG	1142 x 635 x 815

[www.ipmaindustry.com](http://www.ipmaindustry.com)

Details provided about the properties and usability of the products are purely for information purposes and do not constitute a guarantee of these characteristics. The extent of goods delivered and services performed is determined by the subject matter of the specific contract. No liability accepted for errors or omissions.

# IPMA

Your One Stop Rice Processing And Solution Centre!



# Technical Specification

## High Pressure Blower

Model : HPB-55 / HPB-150  
HPB-200

### Direct drive blowers

FRONT VIEW

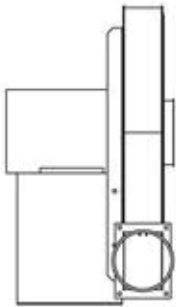

SIDE VIEW

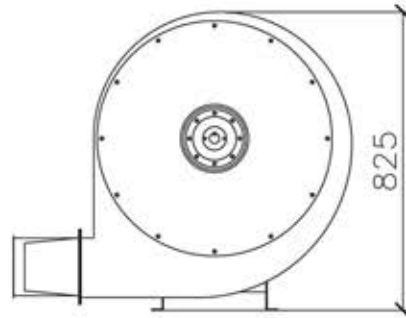

TOP VIEW

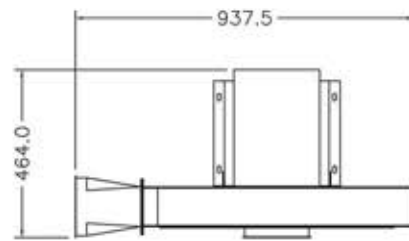

HPB-55

FRONT VIEW

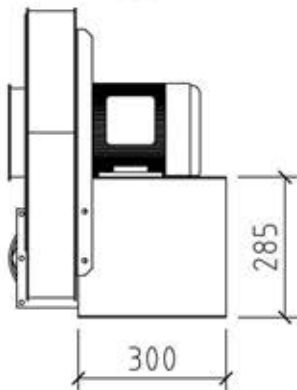

SIDE VIEW

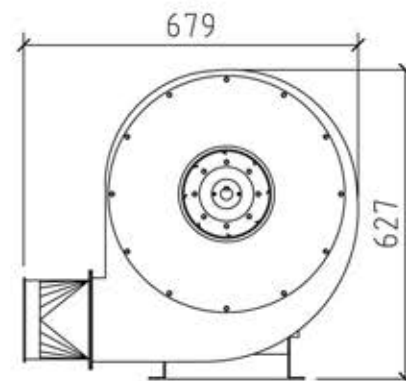

TOP VIEW

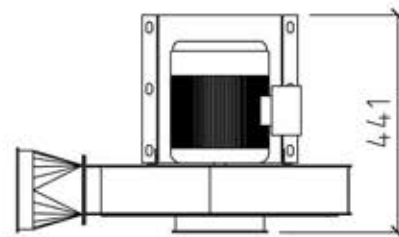

HPB-200

### V-belt drive blowers

FRONT VIEW

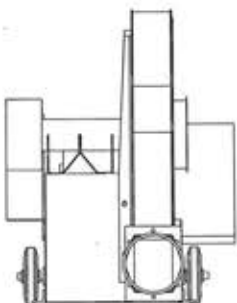

SIDE VIEW

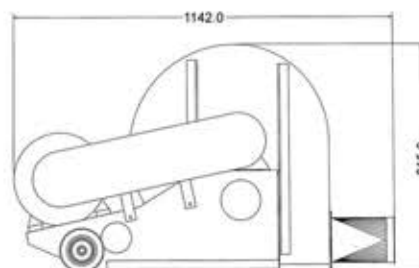

TOP VIEW

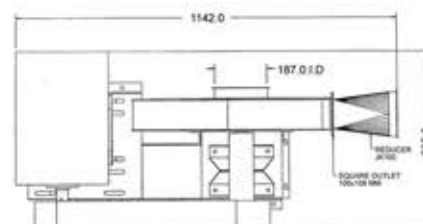

HPB-150

